

# parts list

## OVERVIEW OF STANDARD MODELS

MODEL	MQ10	MQ8/15	MQ4m	MQ10/20	MQ15	MQ5m	MQ15/20	MQ20	MQ20/30	MQ30	*MQ20 Hex	**MQ10mHex	**MQ40 Hex
dimensions imperial metric	10' x 10' 3.048 x 3.048 m	8'9" x 15' 2.667 x 4.572 m	13'1.5" x 13'1.5" 4 x 4 m	10' x 20' 3.048 x 6.096 m	15' x 15' 4.572 x 4.572 m	16'4.8" x 16'4.8" 5 x 5 m	15' x 20' 4.572 x 6.096 m	20' x 20' 6.096 x 6.096 m	20' x 30' 6.096 x 9.144 m	30' x 30' 9.144 x 9.144 m	17'3.8"-20" 5.278 - 6.096 m	28'5"-32'9.64" 8.66 - 10 m	34' 7.7" - 40" 10.558 - 12.192 m
total area imperial metric	100 sq.ft 9.29 m <sup>2</sup>	131.25 sq. ft 12.17 m <sup>2</sup>	172.22 sq. ft 16 m <sup>2</sup>	200 sq. ft 18.58 m <sup>2</sup>	225 sq. ft 20.903 m <sup>2</sup>	289.08 sq. ft 25 m <sup>2</sup>	300 sq. ft 27.871 m <sup>2</sup>	400 sq. ft 37.161 m <sup>2</sup>	600 sq. ft 55.742 m <sup>2</sup>	900 sq. ft 83.613 m <sup>2</sup>	259.8 sq. ft 24.136 m <sup>2</sup>	699.137 sq. ft 64.952 m <sup>2</sup>	1039.23 sq. ft 96.547 m <sup>2</sup>
peak height	12' 8.5" 3.873 m	14' 4.267 m	14' 1" 4.292 m	16' 9.75" 5.124 m	14' 1.5" 4.305 m	16' 9.75" 5.124 m	16' 7.75" 5.073 m	16' 9.75" 5.124 m	18' 4.75" 5.607 m	19' 5" 5.918 m	15' 7" 4.749 m	20' 3" 6.172 m	22' 2" 6.756 m
shipping weight	130 lbs 58.9 kg	170 lbs 77.1 kg	95 lbs 43 kg	179 lbs 81.1 kg	189 lbs 85.7 kg	222 lbs 100.7 kg	215 lbs 97.5 kg	241 lbs 109.3 kg	485 lbs 219.9 kg	585 lbs 265.3 kg	242 lbs 109.7 kg	370 lbs 167.8 kg	478 lbs 216.8 kg
cast aluminum foot plate	4	4	4	4	4	4	4	4	4	4	6	6	6
90 degree cast aluminum corner c/w fittings for sliding wall	4	4	4	4	4	4	4	4	4	4	6	6	6
120 degree cast aluminum corner											6	6	6
Tubes needed for 8' [2.438 m] legs		2			4		2	4				**	**
5' [1.524 m] plus connecting sleeve					4		2	4					
8' [2.438 m]	4	6	4	4	4	4	4	4			6	6	
9' 3" [2.819 m]	4	2	4	6	4	4	6	8	4	10	12	24	6
12' 4.5" [3.772 m]			4										6
15' 7.87" [4.772 m]			4			4						6	6
19' 3" [5.867 m]								4					6
Tubes needed for 9' 3" [2.819 m] legs connecting eave sleeves				2			2	4					
Tsleeve										6			
cross cables	2	2	2	2	2	2	2	2	2	2	3	3	3
guy ropes	4	4	4	4	4	4	4	4	4	10	12	6 double	6 double
center pole assembly c/w flag staff and adjuster	1	1	1	1	1	1	1	1	1	1	1	1	1
pennants; set of 4 assorted colours	1	1	1	1	1	1	1	1	1	1	1	1	1
brace assembly										4			
lynch pin	1	1	1	1	1	1	1	1	1	1	1	1	1
22" [55.88 cm] stakes	4	8	8	8	8	8	8	8	20	24	12	18	18
top c/w 4 rope ratchets and wrap bag	1	1	1	1	1	1	1	1	1	1	1	1	1
color code I.D.; each item unique to a size has a identifying colour key	black	white	white	white	yellow	claret	white	blue	green	red	blue	claret	white

### Detailed parts lists, options and accessories available on request

Frame: 2.5" [6.35 cm] anodized structural aluminum alloy

Ropes: double braided polyester cord

Warranty: Lifetime guarantee on all castings

One year on materials and workmanship to the original owner

\*\*\* = Can be used as a single piece eave for MQ20

### Engineering report available to qualified engineers

Fabric: Opaque white vinyl-coated polyester certified by the California State Fire Marshall exceeding requirements for NFPA 701, UL 214, ULC S-109 and M1

Treated to resist mildew, ultra-violet degradation

Flame retardant

All rights reserved. Reproduction in whole or in part without permission is prohibited.



**Tentnology® Co.**  
15427-66th Avenue, Surrey  
British Columbia, Canada V3S 2A1

Tel: 604 597-8368

Fax: 604 597-8749

Order Line - Canada & USA: 1 800 663-8858

- International : + 800 627-78337

Website: www.tentnology.com

Email: tent@tentnology.com



# marquee specs

The original premium quality frame tent designed with advanced tension structure principles. Featuring impressive strength, elegant form and ease of assembly. **Marquee for the new millennium.**

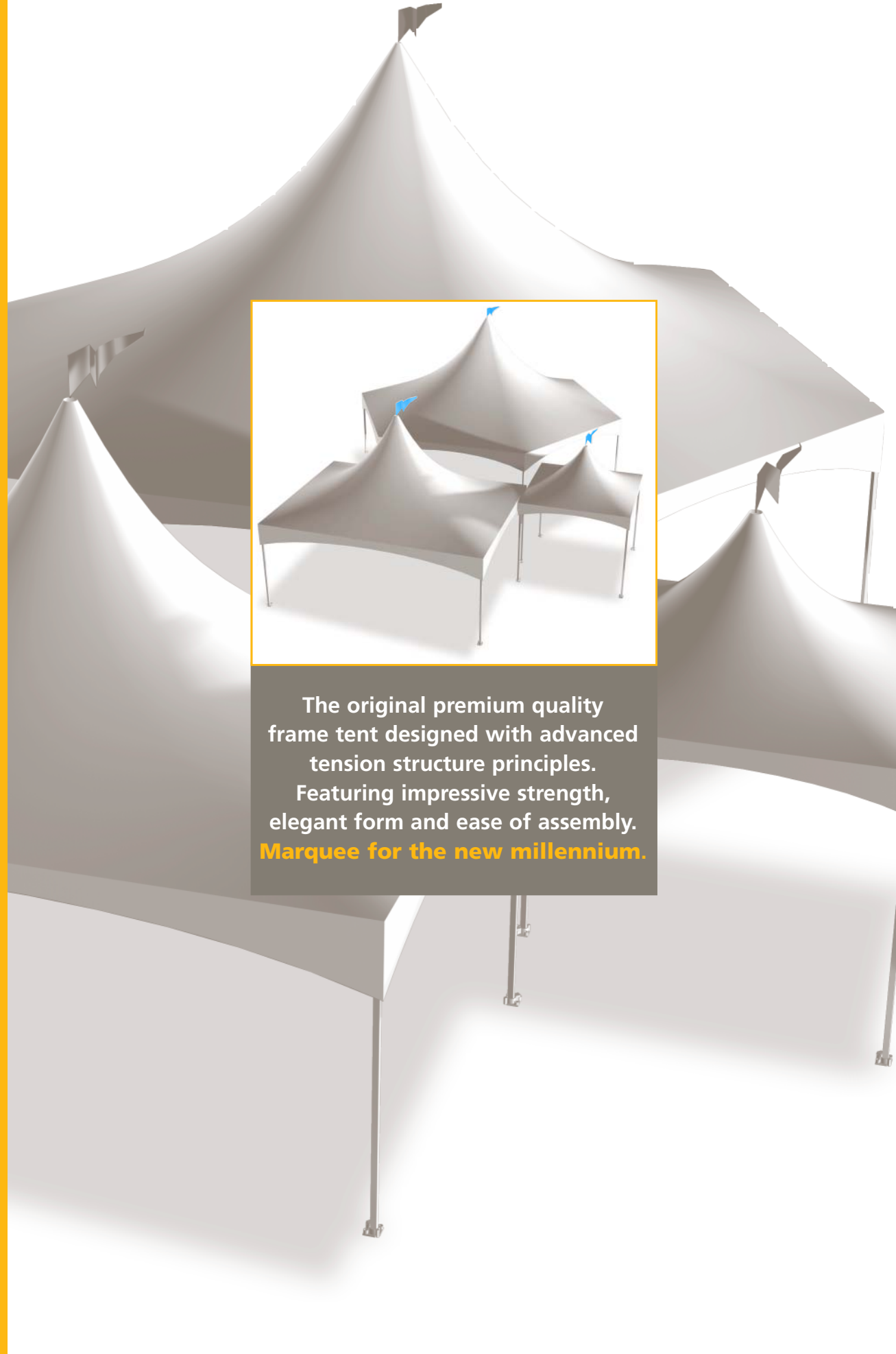

# SIZES

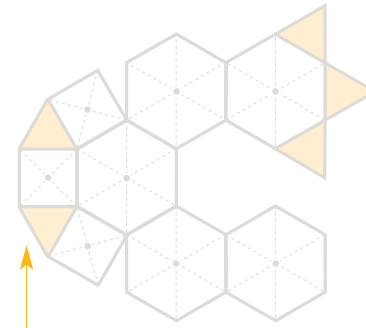
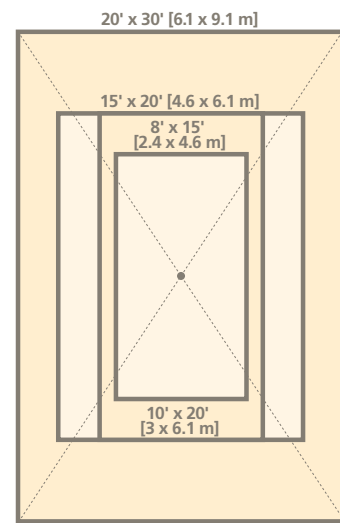
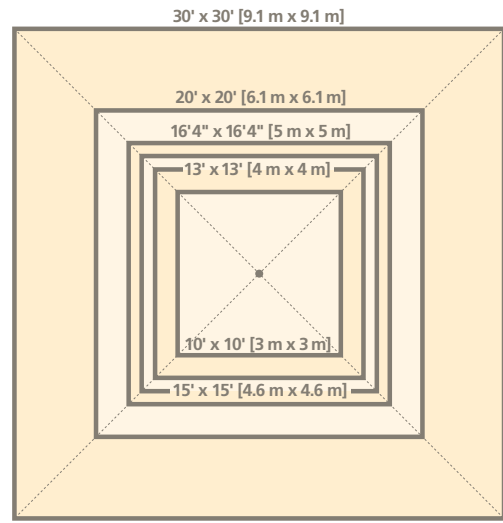

**New Triangular Marquee...**  
Imagine the possibilities. Cover and create your own amazing space using Hexagon's squares and triangles. Tentnology's<sup>®</sup> revolutionary solutions to any odd shape or space.

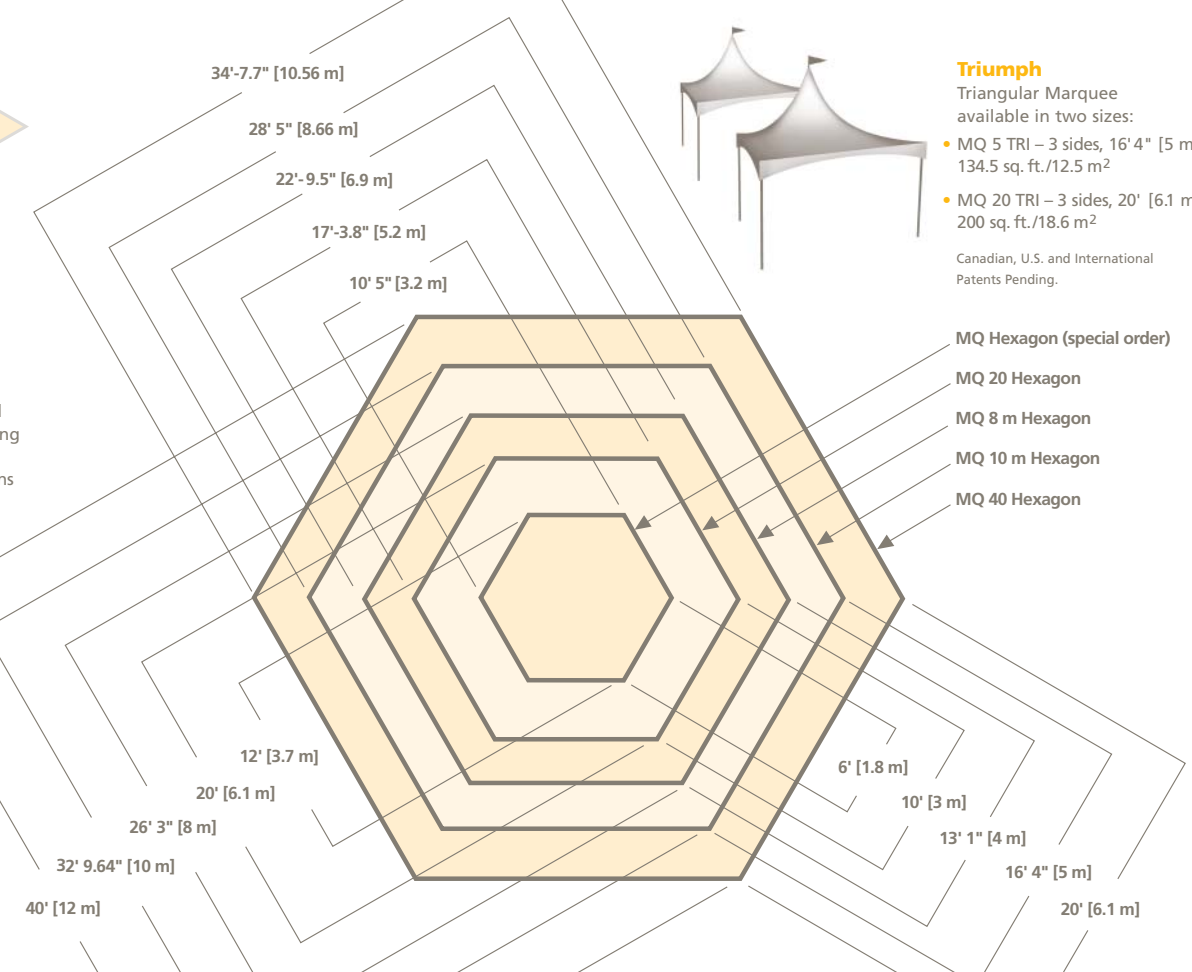

**Triumph**  
Triangular Marquee available in two sizes:  
• MQ 5 TRI – 3 sides, 16' 4" [5 m] 134.5 sq. ft./12.5 m<sup>2</sup>  
• MQ 20 TRI – 3 sides, 20' [6.1 m] 200 sq. ft./18.6 m<sup>2</sup>  
Canadian, U.S. and International Patents Pending.

MQ Hexagon (special order)  
MQ 20 Hexagon  
MQ 8 m Hexagon  
MQ 10 m Hexagon  
MQ 40 Hexagon

**Expandable – gutters connect units for an unlimited variety of sizes and configurations.**

- every square foot of tent is usable anytime, all the time
- the same skills needed for one or a thousand tents

**Interchangeable parts** – most parts are universal, making purchasing, handling and inventory management efficient and economical.

- **Engineered** – for extreme weather conditions
- **Customized** – colours and graphics available
- **40% less parts** than traditional frame tents
- **Magnum slip fit parts** for maximum strength and durability

# hexagon

# ISO9002

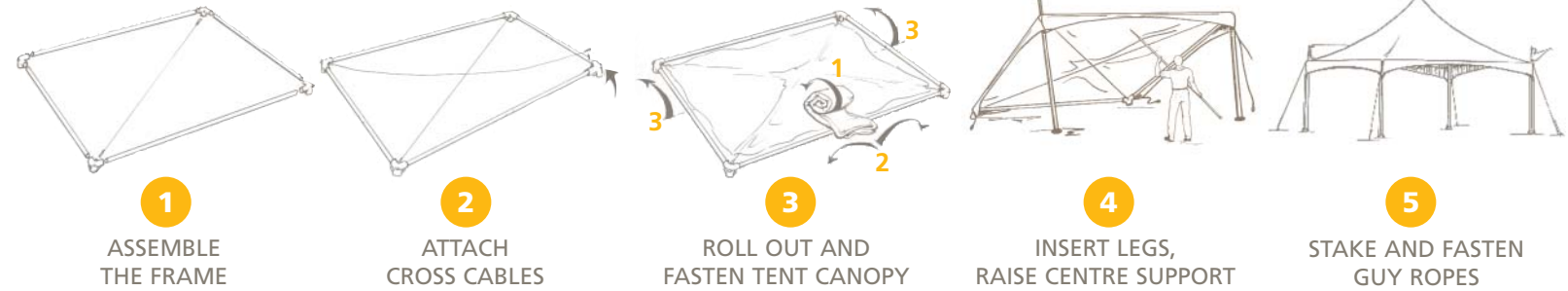
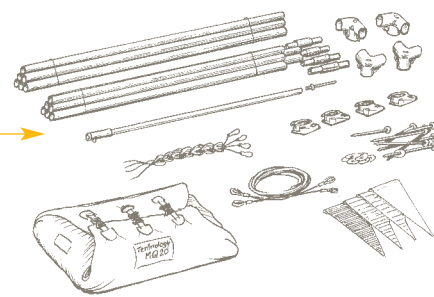

12" [30.48 cm]  
Flag Staff optional

- 20' [6.1 m]
- 15' [4.6 m]
- 9'3" [2.82 m]
- 8' [2.43 m]
- 0' [0 m]

