

# VP WALL SYSTEMS

STYLE	FEATURES
<b>TECH FOUR WALL PANEL</b>	ATTRACTIVE ARCHITECTURAL METAL WALL SYSTEM COMBINES SMART DESIGN WITH ENERGY EFFICIENT PERFORMANCE

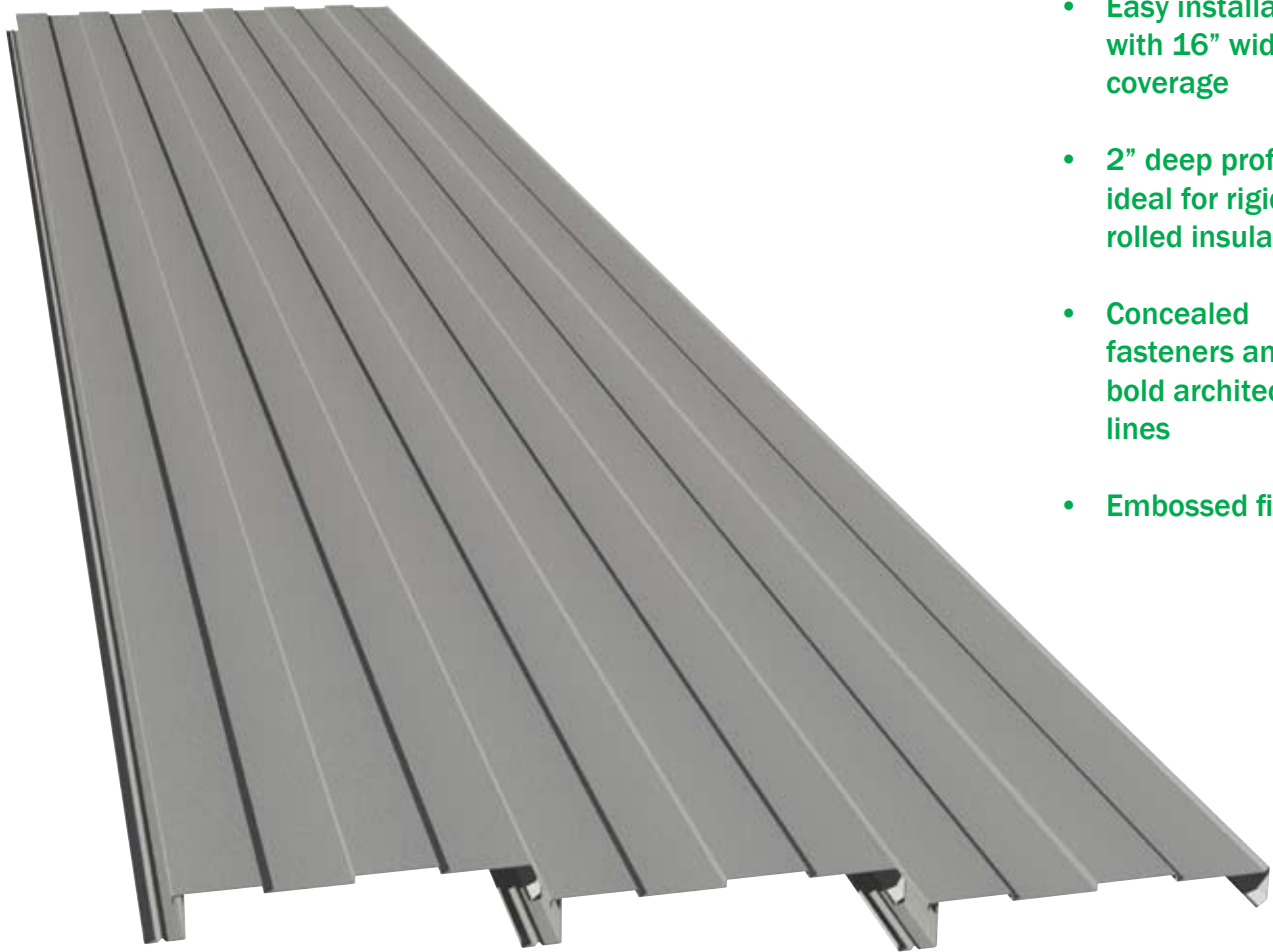

- Easy installation with 16" wide coverage
- 2" deep profile ideal for rigid or rolled insulation
- Concealed fasteners and bold architectural lines
- Embossed finish

**T**ech Four wall panel is the smart choice for commercial and industrial projects — can be easily insulated with a wide variety of insulation systems: batt, blanket, or rigid board.

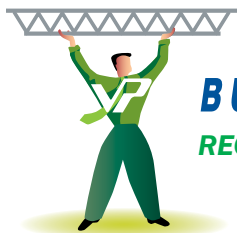

**BUILD SMART BUILD GREEN WITH VP**  
RECYCLED STEEL COOL PAINTS ENERGY SAVING INSULATION



# AN ATTRACTIVE WALL PANEL WITH BOLD ARCHITECTURAL LINES AND CONCEALED FASTENERS

## TECH FOUR WALL PANEL

A unique architectural wall system that is easy to install featuring concealed fasteners and an attractive, embossed finish.

Tech Four offers 16" coverage with 1/4" high, 4" wide alternating fluted profile. Available in lengths of up to 40', Tech Four can provide continuous coverage from foundation to eave – eliminating the need for end laps and assuring superior weather tightness. Manufactured in sturdy 24 gauge steel for added strength and erectability.

Tech Four's 2" deep overall profile easily adapts to a variety of insulation options (including batt, blanket or rigid board) creating a more energy-efficient building envelope.

Available in VP's long-life KXL finish with 70% PVDF (Kynar 500 or Hylar 5000). Color options shown below.

Tech Four's interlocking fastener locations give the panel a concealed profile with bold architectural lines. A complete trim package including gutter and rake trim, corners and base trim are available to provide an attractive finished appearance.

Cool Egyptian White

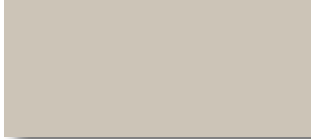

Cool Granite Gray



Cool Straw Gold



Cool Cobalt Blue



Cool Leaf Green



### FEATURES

- 16" coverage
- 24 gauge painted Galvalume® steel
- Fast installation
- Lengths up to 40' which can provide a continuous panel from eave to foundation.
- Economical

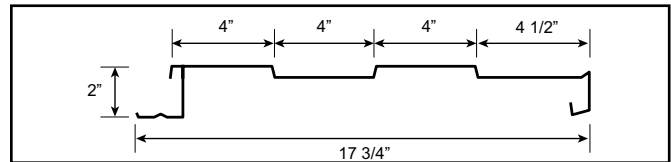

Note: All panels formed from light gauge metal may exhibit waviness, also known as "Oil Canning," commonly occurring in, but not restricted to, flat portions of a panel. This inherent characteristic is not a defect of material or manufacturing and is not cause for rejection.

Tech Four finishes meet Kynar 500 and Hylar 5000 specifications. KYNAR® is a registered trademark of Atochem North America, Inc. ©2009 BlueScope Buildings North America, Inc. All rights reserved. Hylar 5000® is a registered trademark of Solvay Solexis. Galvalume® is a registered trademark of BIEC International, Inc.



2068 Issued 9/09  
 Varco Pruden Buildings, 3200 Players Club Circle, Memphis, TN 38125  
 ©2009 BlueScope Buildings North America, Inc. All rights reserved.  
 Varco Pruden Buildings® is a division of BlueScope Buildings North America, Inc.  
 Find your independent Authorized VP Builder at [www.vp.com](http://www.vp.com)

